

銅合金凸緣自潤軸承 SPF

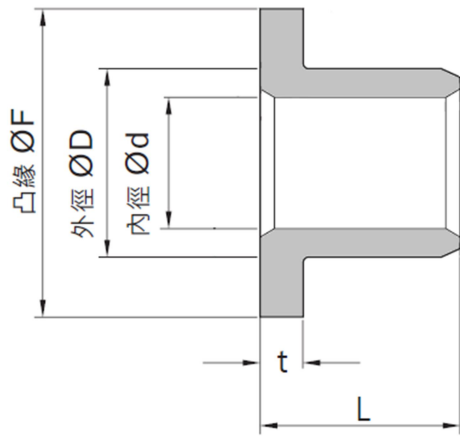

內徑		外徑		凸 緣		長 度 L 公差																			
ød	公差	øD	公差	øF	t	公差	10	12	15	17	18	20	23	25	30	35	40	50	60	67.5	80	100	120		
6	+0.032 +0.020	10	+0.028 +0.019	16	2	0 -0.1	0610	0612																	
8	+0.040 +0.025	12		20				081	0812	0815															
10		14	+0.034 +0.023	22			1010	1012	1015	1017		1020													
12		18		25			1210	1212	1215		1220		1225	1230											
13		19		26			1310	1312	1315		1320		1325	1330											
14	+0.050 +0.032	20		27	3				1415		1420		1425												
15		21		28				1510	1512	1515		1520		1525	1530										
16		22	+0.041 +0.028	29					1612	1615	1618	1620	1623	1625	1630	1635	1640								
18		24		32						1815		1820		1825	1830	1835	1840								
20		30		40					2015		2020		2025	2030	2035	2040									
25	+0.061 +0.040	35		45					2515		2520		2525	2530	2535	2540	2550								
30		40		50							3020		3025	3030	3035	3040	3050								
31.5		40	+0.050 +0.034	50	5						3120			3130	3135	3140									
35		45		60								3520		3525	3530	3535	3540	3550							
40	+0.075 +0.050	50		65								4020		4025	4030	4035	4040	4050							
45		55		70											4530	4535	4540	4550	4560						
50		60	+0.060 +0.041	75											5030	5035	5040	5050	5060						
55		65		80												5540	5550	5560							
60		75		90											6040	6050	6060	6080							
63		75	+0.062 +0.043	85	7.5													6560	6367						
65	+0.090 +0.060	80		95															7050		7080				
70		85		105																					
75		90	+0.073 +0.051	110															7560						
80		100		120														8060		8080	80100				
90		110	+0.076 +0.054	130														9060		9080					
100	+0.107 +0.072	120		150																10080	100100				
120		140	+0.088 +0.063	170	10																12080	120100			
130		150	+0.090 +0.065	180																		*13080	*130100		
140		160		190																		*14080	*140100		
150	+0.125 +0.085	170	+0.093 +0.068	200																			*150100	*150120	
160		180		210																				*160100	*160120